

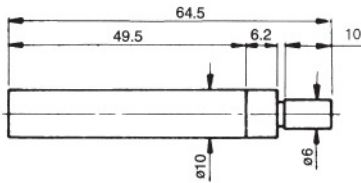

VPS-201



This series is a high precision setting device for positioning the accurate center between tool spindle of machine and reference surface of working at low-cost and saving time.

Accuracy : within 0.005 mm

Made of tool steel, hardened and ground.

Suitable rotation speed : VPS-201 450 to 600rpm.

VPS-401 600 to 1,000 rpm



CREAMIC TYPE VPS-201C



MECHANICAL TYPE SIMPLE TYPE

ORDER NO.	VPS-201	VPS-201C
WEIGHT (KG)	0.03	0.06
CODE NO.	3402-005	3402-007

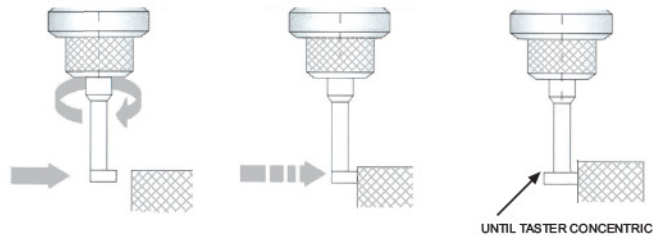

Deluxe Type



VPS-401



VPS-401C

FEATURES:

- Material: high-carbon steel.
- Accuracy: within 0.003mm
- Hardness: HRC 58 \pm 1°
- R.P.M. Within 600-1000
- Suitable for milling machine.
Drill machine and boring machine.

VPS-401 (2 PCS/SET)

VPS-402A(LONG) SINGLE

VPS-402B(SHORT) SINGLE

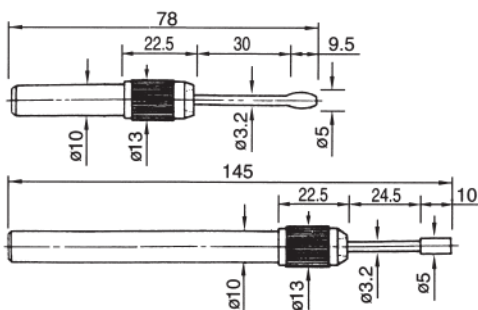

ORDER NO.	VPS-401	VPS-401C
PCS/SET	2PCS/SET	2PCS/SET
WEIGHT (KG)	0.26	0.26
CODE NO.	3402-006	3402-008

EXAMPLES-APPLICATION

