

STEEL SQUARE (AA TYPE)



FIRST GRADE(Hardened)



USE

- Measurement of squareness

MATERIAL

- Carbon steel for machine structural use (hardened measuring face)
- Hardness: over HV450

FEATURES

- Dimension and accuracy equivalent to JIS B 7526 (※exceeds JIS)
- Hardened measuring face for abrasion resistance
- All hardened, first grade squares are provided with inspection report

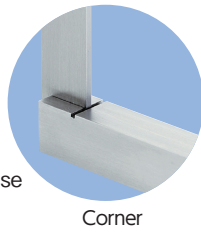

Corner



AA-F150

● DIMENSIONS

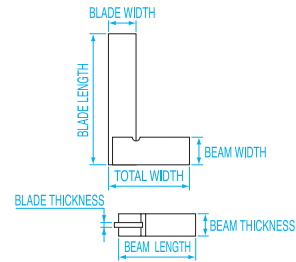

Squareness $\pm (10 + \frac{L}{20}) \mu\text{m}$ (L: Nominal Size)

Order No.	Model No.	Nominal Size (mm)	Blade Length (mm)	Blade Width (mm)	Blade Thickness (mm)	Beam Length (mm)	Beam Width (mm)	Beam Thickness (mm)	Squareness Accuracy (\pm mm)	Weight
002101	AA-F50	※ 50	50			37			0.013	54g
002102	AA-F75	75	75	16	2	50	16	10	0.014	72g
002103	AA-F100	100	100			70			0.015	150g
002104	AA-F125	※ 125	125	20	2.5	80	18	12	0.016	175g
002105	AA-F150	150	150	24	3	100	22	18	0.018	365g
002107	AA-F200	200	200			130			0.02	685g
002108	AA-F250	※ 250	250	29	3.5	165	26	22	0.022	900g
002109	AA-F300	300	300	35	4		32		0.025	1.5kg
002111	AA-F400	※ 400	400	40		200	40	27	0.03	2.1kg
002113	AA-F500	500	500	46	5	300	45		0.035	4.3kg
002114	AA-F600	※ 600	600	50		320	55	35	0.04	5.7kg
002115	AA-F750	750	750	58	6	400	63	50	0.048	11.3kg
002117	AA-F1000	1000	1000	65		550	80	65	0.06	24.5kg
002119	AA-F1500	※ 1500	1500	90	10.0	600	90	80	0.085	39.1kg
002121	AA-F2000	※ 2000	2000	100		800	105	90	0.11	72.5kg

SECOND GRADE (Non-hardened)

FEATURES

- Dimension and accuracy equivalent to JIS B 7526 (※exceeds JIS)
- Non-hardened·Ground finish

Squareness $\pm (20 + \frac{L}{10}) \mu\text{m}$ (L: Nominal Size)

Order No.	Model No.	Nominal Size (mm)	Blade Length (mm)	Blade Width (mm)	Blade Thickness (mm)	Beam Length (mm)	Beam Width (mm)	Beam Thickness (mm)	Squareness Accuracy (\pm mm)	Weight
002201	AA-S50	※50	50			37			0.025	54g
002202	AA-S75	75	75	16	2	50	16	10	0.027	72g
002203	AA-S100	100	100			70			0.03	150g
002204	AA-S125	※125	125	20	2.5	80	18	12	0.032	175g
002205	AA-S150	150	150	24	3	100	22	18	0.035	365g
002207	AA-S200	200	200			130			0.04	695g
002208	AA-S250	※250	250	29	3.5	165	26	22	0.045	900g
002209	AA-S300	300	300	35	4		32		0.05	1.5kg
002211	AA-S400	※400	400	40		200	40	27	0.06	2.1kg
002213	AA-S500	500	500	46	5	300	45		0.07	4.3kg
002214	AA-S600	※600	600	50		320	55	35	0.08	5.7kg
002215	AA-S750	750	750	58	6	400	63	50	0.095	11.3kg
002217	AA-S1000	1000	1000	65		550	80	65	0.12	24.2kg
002219	AA-S1500	※1500	1500	90	10	600	90	80	0.17	38.2kg
002221	AA-S2000	※2000	2000	100		800	105	90	0.22	70.9kg

COMPARATOR

GRANITE PRODUCTS

CAST IRON SURFACE PLATE

PARALLEL BLOCK



V BLOCK

SQUARE

STRAIGHT EDGE

PARALLEL CLAMP

STEEL SQUARE (DD TYPE)

FIRST GRADE(Hardened)

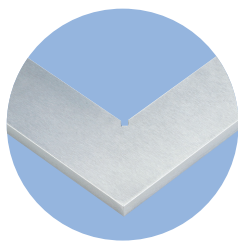
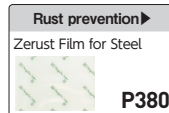

Corner



DIMENSIONS

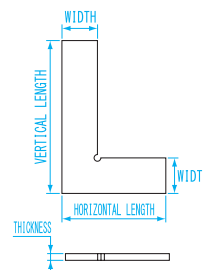

USE

- Measurement of squareness

MATERIAL

- Carbon steel for machine structural use (hardened measuring face)
- Hardness: over HV450

FEATURES

- Dimension and accuracy equivalent to JIS B 7526 (※exceeds JIS)
- Hardened measuring face for abrasion resistance
- All hardened, first grade squares are provided with inspection report

$$\text{Squareness} \pm (10 + \frac{L}{20}) \mu\text{m} \quad (L: \text{Nominal Size})$$

Order No.	Model No.	Nominal Size (mm)	Vertical Length (mm)	Horizontal Length (mm)	Width (mm)	Thickness (mm)	Squareness Accuracy (±mm)	Weight
002301	DD-F50	※50	50	38	16	3	0.013	27g
002302	DD-F75	75	75	50	18	3	0.014	45g
002303	DD-F100	100	100	70	20	4	0.015	94g
002304	DD-F125	※125	125	80	25	4	0.016	115g
002305	DD-F150	150	150	100	25	5	0.018	220g
002307	DD-F200	200	200	130	30	5	0.02	360g
002308	DD-F250	※250	250	165	30	6	0.022	450g
002309	DD-F300	300	300	200	40	6	0.025	660g
002311	DD-F400	※400	400	300	40	8	0.03	1.5kg
002313	DD-F500	500	500	325	50	8	0.035	2.0kg
002314	DD-F600	※600	600	400	50	10	0.04	3.4kg
002315	DD-F750	750	750	400	60	10	0.048	4.2kg
002317	DD-F1000	1000	1000	550	60	12	0.06	8.3kg
002319	DD-F1500	※1500	1500	750	80	12	0.085	17.4kg

COMPARATOR

GRANITE PRODUCTS

CAST IRON SURFACE PLATE

PARALLEL BLOCK

SECOND GRADE (Non-Hardened)

FEATURES

- Dimension and accuracy equivalent to JIS B 7526 (※exceeds JIS)
- Non-hardened·Ground finish

$$\text{Squareness} \pm (20 + \frac{L}{10}) \mu\text{m} \quad (L: \text{Nominal Size})$$

Order No.	Model No.	Nominal Size (mm)	Vertical Length (mm)	Horizontal Length (mm)	Width (mm)	Thickness (mm)	Squareness Accuracy (±mm)	Weight
002401	DD-S50	※50	50	38	16	3	0.025	27g
002402	DD-S75	75	75	50	18	3	0.027	45g
002403	DD-S100	100	100	70	20	4	0.03	94g
002404	DD-S125	※125	125	80	25	4	0.032	115g
002405	DD-S150	150	150	100	25	5	0.035	220g
002407	DD-S200	200	200	130	30	5	0.04	360g
002408	DD-S250	※250	250	165	30	6	0.045	450g
002409	DD-S300	300	300	200	40	6	0.05	660g
002411	DD-S400	※400	400	300	40	8	0.06	1.5kg
002413	DD-S500	500	500	325	50	8	0.07	2.0kg
002414	DD-S600	※600	600	400	50	10	0.08	3.4kg
002415	DD-S750	750	750	400	60	10	0.095	4.2kg
002417	DD-S1000	1000	1000	550	60	12	0.12	8.3kg
002419	DD-S1500	※1500	1500	750	80	12	0.17	17.4kg

V BLOCK

SQUARE

STRAIGHT EDGE

PARALLEL CLAMP

STEEL SQUARE WITH METRIC GRADUATED BLADE (C TYPE)

T MTO products
400mm or larger

Rust prevention▶
Zerust Film for Steel
P380



C-150

● DIMENSIONS

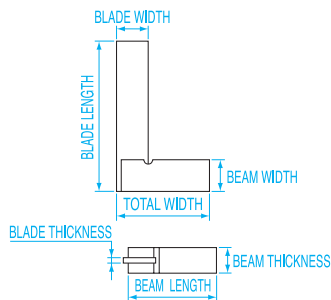

USE

- Measurement of squareness

MATERIAL

- Carbon steel for machine structural use

FEATURES

- Graduated with 1mm division
- Accuracy equivalent to JIS Grade 2

Squareness $\pm (20 + \frac{L}{10}) \mu m$ (L: Nominal Size)

Order No.	Model No.	Nominal Size (mm)	Blade Length (mm)	Blade Width (mm)	Blade Thickness (mm)	Base Length (mm)	Base Width (mm)	Base Thickness (mm)	Graduation Accuracy (±mm)	Squareness (±mm)	Weight
002503	C-100	100	100	20	2.5	70	19	12	0.4	0.03	150g
002505	C-150	150	150	24	3	100	22	18		0.035	365g
002507	C-200	200	200	29	3.5	130	26	22		0.04	700g
002508	C-250	250	250			165	26	22		0.045	900g
002509	C-300	300	300	35	4	200	32	27		0.05	1.5kg
002511	C-400	400	400	40	4		40	27		0.06	2.1kg
002513	C-500	500	500	46	5	300	45	35		0.07	4.3kg
002515	C-600	600	600	50	5	320	55			0.08	5.7kg
002523	C-1000	1000	1000	65	10.0	550	80	65		0.12	24.2kg

PRECISION SQUARE WITH METRIC GRADUATED BLADE (E TYPE)

T MTO products
400mm or larger

Rust prevention▶
Zerust Film for Steel
P380



E-150

● DIMENSIONS

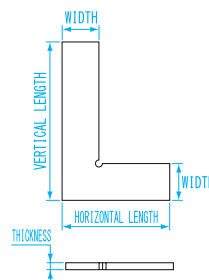

USE

- Measurement of squareness

MATERIAL

- Carbon steel for machine structural use

FEATURES

- Graduated with 1mm division
- Accuracy equivalent to JIS Grade 2

Squareness $\pm (20 + \frac{L}{10}) \mu m$ (L: Nominal Size)

Order No.	Model No.	Nominal Size (mm)	Vertical Length (mm)	Horizontal Length (mm)	Width (mm)	Thickness (mm)	Graduation Accuracy (±mm)	Squareness (±mm)	Weight
002603	E-100	100	100	70	20	4	0.4	0.03	94g
002605	E-150	150	150	100	25	5		0.035	220g
002607	E-200	200	200	130	30	6		0.04	360g
002608	E-250	250	250	165		6		0.045	450g
002609	E-300	300	300	200	40	8		0.05	660g
002611	E-400	400	400					8	0.06
002613	E-500	500	500	300	50	10		0.07	2.0kg
002615	E-600	600	600	325				10	0.08
002623	E-1000	1000	1000	550	60	12		0.12	8.3kg

COMPARATOR

GRANITE PRODUCTS

CAST IRON SURFACE PLATE

PARALLEL BLOCK

V BLOCK

SQUARE

STRAIGHT EDGE

PARALLEL CLAMP

HEAVY DUTY STEEL SQUARE (HDD TYPE)



Rust prevention ▶
Zerust Film for Steel
P380

USE

- Measurement of squareness

MATERIAL

- Carbon steel for machine structural use (hardened)

FEATURES

- The heavy duty 'DD' type is engineered for ultimate stability
- Provided with inspection report



● DIMENSIONS

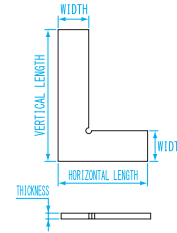

Squareness $\pm (10 + \frac{L}{20}) \mu m$ (L: Nominal Size)

Order No.	Model No.	Nominal Size (mm)	Vertical Length (mm)	Base Length (mm)	Width (mm)	Thickness (mm)	Squareness Accuracy ($\pm mm$)	Weight
003501	HDD-50	50	50	35	15	10	0.013	82g
003502	HDD-75	75	75	50	18	12	0.014	180g
003503	HDD-100	100	100	70	20	15	0.015	350g
003505	HDD-150	150	150	100	25	20	0.018	880g
003507	HDD-200	200	200	130	30	20	0.02	1.4kg
003508	HDD-250	250	250	165	30	25	0.022	2.3kg
003509	HDD-300	300	300	200	35	25	0.025	3.2kg

STEEL SQUARE WITH FLUSH MOUNTED BEAM



Rust prevention ▶
Zerust Film for Steel
P380

USE

- Measurement of squareness

MATERIAL

- Carbon steel for machine structural use

FEATURES

- Available in "right handed" and "left handed" versions
- Accuracy equivalent to JIS Grade 2

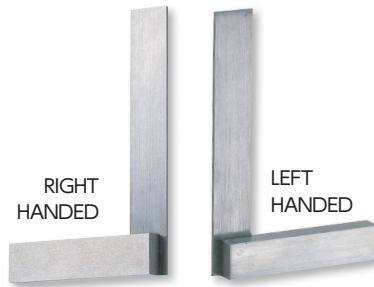

● DIMENSIONS

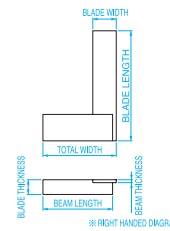

The product with it's accuracy equivalent to JIS Grade 1 is also available on request
(Squareness $\pm (10 + \frac{L}{20}) \mu m$) is made to order

Squareness $\pm (20 + \frac{L}{10}) \mu m$ (L: Nominal Size)

RIGHT HANDED

Order No.	Model No.	Nominal Size (mm)	Blade Length (mm)	Blade Width (mm)	Blade Thickness (mm)	Beam Length (mm)	Beam Thickness (mm)	Squareness ($\pm mm$)	Weight
003002	TRS-R75	75	75	16	2	50	10	0.027	72g
003003	TRS-R100	100	100	20	2.5	70	12	0.03	150g
003005	TRS-R150	150	150	24	3	100	18	0.035	365g
003007	TRS-R200	200	200	29	3.5	130	22	0.04	700g
003009	TRS-R300	300	300	35	4	200	27	0.05	1.5kg
003011	TRS-R400	400	400	40	4	200	27	0.06	2.1kg
003013	TRS-R500	500	500	46	5	300	35	0.07	4.3kg
003015	TRS-R600	600	600	50	5	320	35	0.08	5.7kg
003018	TRS-R750	750	750	58	6	400	50	0.095	11.3kg
003023	TRS-R1000	1000	1000	65	6	550	65	0.12	24.2kg
003025	TRS-R1500	1500	1500	90	10	600	80	0.17	38.2kg
003027	TRS-R2000	2000	2000	100	10	800	90	0.22	70.9kg

LEFT HANDED

Order No.	Model No.	Nominal Size (mm)	Blade Length (mm)	Blade Width (mm)	Blade Thickness (mm)	Beam Length (mm)	Beam Thickness (mm)	Squareness ($\pm mm$)	Weight
003102	TRS-L75	75	75	16	2	50	10	0.027	72g
003103	TRS-L100	100	100	20	2.5	70	12	0.03	150g
003105	TRS-L150	150	150	24	3	100	18	0.035	365g
003107	TRS-L200	200	200	29	3.5	130	22	0.04	700g
003109	TRS-L300	300	300	35	4	200	27	0.05	1.5kg
003111	TRS-L400	400	400	40	4	200	27	0.06	2.1kg
003113	TRS-L500	500	500	46	5	300	35	0.07	4.3kg
003115	TRS-L600	600	600	50	5	320	35	0.08	5.7kg
003118	TRS-L750	750	750	58	6	400	50	0.095	11.3kg
003123	TRS-L1000	1000	1000	65	6	550	65	0.12	24.2kg
003125	TRS-L1500	1500	1500	90	10	600	80	0.17	38.2kg
003127	TRS-L2000	2000	2000	100	10	800	90	0.22	70.9kg

COMPARATOR

GRANITE PRODUCTS

CAST IRON SURFACE PLATE

PARALLEL BLOCK



V BLOCK

SQUARE

STRAIGHT EDGE

PARALLEL CLAMP

BLADE STEEL SQUARE I-TYPE

Made by hardened steel. Knife-shaped blade for precise right angle measurement.



AAI-150K

● DIMENSIONS

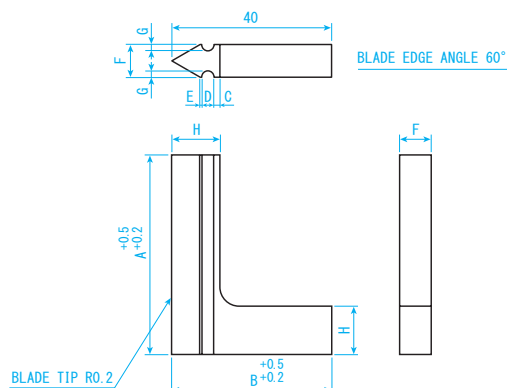

USE

- For precise right angle measurement

MATERIAL

- Carbon steel for machine structural use (hardened)

FEATURES

- Knife-shaped outer blade reflects light ray on object to be measured for clearance inspection

Units: mm

Model No.	A	B	C	D	E	F	G	H
AAI-100K	100	70	2.5	6	1.5	12	2	20
AAI-150K	150	100		8		14		24

Squareness $\pm (2 + \frac{L}{100}) \mu\text{m}$ (L: Nominal Size)

Order No.	Model No.	Nominal Size (mm)	Squareness Accuracy ($\pm \mu\text{m}$)	Weight
003601	AAI-100K	100	3.0	240g
003602	AAI-150K	150	3.5	530g

COMPARATOR

GRANITE PRODUCTS

CAST IRON SURFACE PLATE

PARALLEL BLOCK

V BLOCK

V BLOCK

SQUARE

STRAIGHT EDGE

PARALLEL CLAMP

PARALLEL CLAMP

PARALLEL CLAMP

PARALLEL CLAMP

PARALLEL CLAMP

PARALLEL CLAMP

PARALLEL CLAMP

PARALLEL CLAMP

CYLINDRICAL SQUARE

Made by hardened steel. The highest squareness accuracy in the square products.



CS-F100



● DIMENSIONS

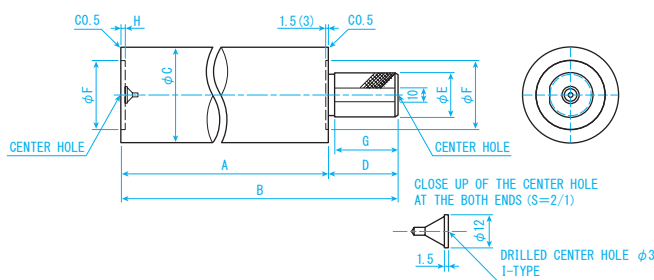

Units: mm

Model No.	A	B	C	D	E	F	G	H
CS-F100	100	140	60	40	30	45	35	3
CS-F150	150	200	70	50	32	50	45	
CS-F200	200	260	80	60			60	55

Squareness and perpendicularity to the axis $\pm (10 + \frac{L}{20}) \mu\text{m}$ (L: Nominal Size)

Order No.	Model No.	Nominal Size (mm)	Squareness Accuracy ($\pm \mu\text{m}$)	Weight
003621	CS-F100	100	2.5	2.5kg
003622	CS-F150	150	2.8	4.9kg
003623	CS-F200	200	3.0	8.3kg

T-SQUARE

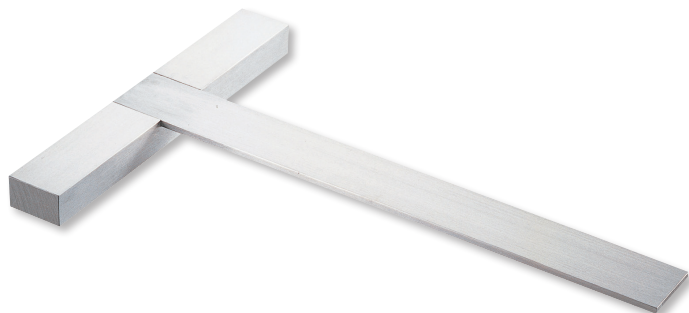

● DIMENSIONS

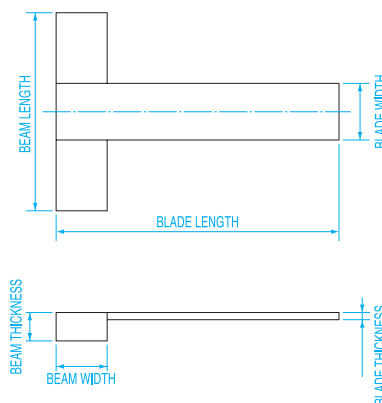

USE

- For general engineering work or marking work

MATERIAL

- Carbon steel for machine structural use

FEATURES

- The blade and beam are permanently secured by rivets

$$\text{Squareness} \pm (20 + \frac{L}{10}) \mu\text{m} \quad (L: \text{Nominal Size})$$

Order No.	Model No.	Nominal Size (mm)	Blade Length (mm)	Blade Width (mm)	Blade Thickness (mm)	Beam Length (mm)	Beam Width (mm)	Beam Thickness (mm)	Straightness (±mm)	Weight
003201	TS-100	100	100	20	2.5	70	18	10	0.03	130g
003202	TS-150	150	150	24	3	100	20	12	0.035	260g
003203	TS-200	200	200	29	3.5	140	24	14	0.04	500g
003204	TS-250	250	250	29		175	26	16	0.045	745g
003205	TS-300	300	300	35	4	200	30	18	0.05	1.2kg
003207	TS-400	400	400	40	5	260	34	20	0.06	2.0kg
003209	TS-500	500	500	46		330	36	22	0.07	2.9kg
003211	TS-600	600	600	50		360	38	24	0.08	3.6kg
003219	TS-1000	1000	1000	65	8	640	45	30	0.12	10.9kg

COMPARATOR

GRANITE PRODUCTS

CAST IRON SURFACE PLATE

PARALLEL BLOCK

FLANGE SQUARE

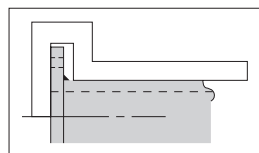
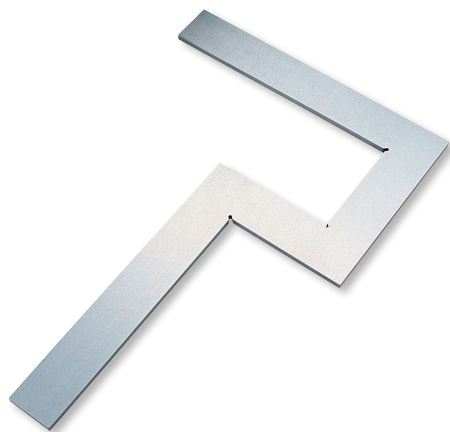

● DIMENSIONS

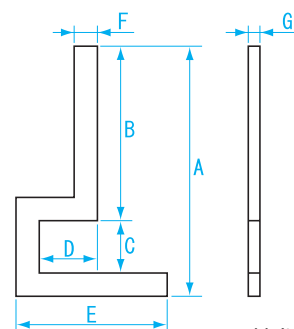

Units: mm

Model No.	A	B	C	D	E	F	G
FS-1	300	200	70	80	200	30	4
FS-2	400	280	90	120	300	30	4
FS-3	750	500	200	250	680	50	6

USE

- Inspection of surfaces with flange, and piping connections

MATERIAL

- Rolled steel for general structure

Order No.	Model No.	Nominal Size (mm)	Straightness (±mm)	Weight
003320	FS-1	200×300	0.037	520g
003330	FS-2	300×400	0.045	750g
003368	FS-3	680×750	0.071	3.7kg

V BLOCK

SQUARE

STRAIGHT EDGE

PARALLEL CLAMP