

# DIGITAL WELDING GAUGE

Essential for welding process. Digital welding gauge specialized for measuring fillet weld and bead weld height  
 Provided with zero setting master gauge



## DIMENSIONS

Units : mm

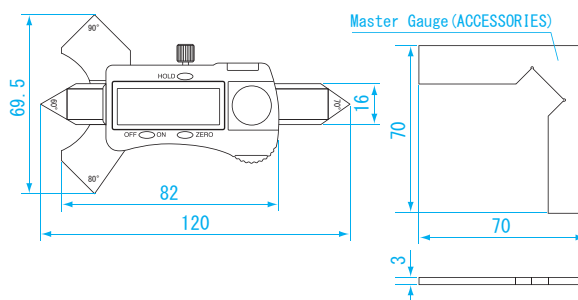

**USE** • For measuring the size of fillet weld and bead weld

**MATERIAL** • Stainless steel

**FEATURES** • Easy to read with digital display  
 • Bevel angle: 60°, 70°, 80°, 90°  
 • Master gauge included  
 • Hold function

### SPECIFICATIONS

- Throat thickness : 20mm
- Bead height : 10mm
- Operating temperature : 0 ~ 40°C

**POWER** • SR44 or LR44, one included for testing

Weld reinforcement height measurement

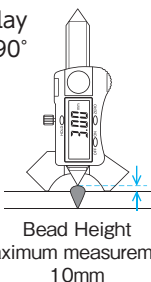

Measurement before welding process

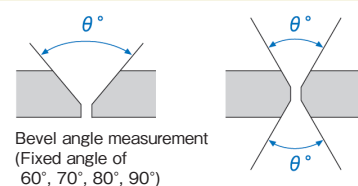
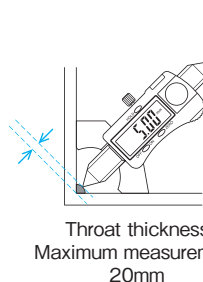

Order No.	Model No.	Resolution (mm)	Accuracy※ (mm)	Weight
007526	DWG-20G	0.01	± 0.03	130g

※ Quantization Error ( ± 1 digit ) not included

# WELDING GAUGE

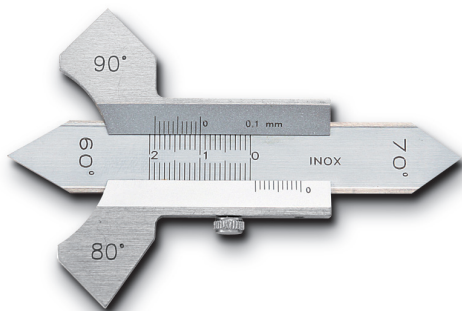

## DIMENSIONS

Units : mm

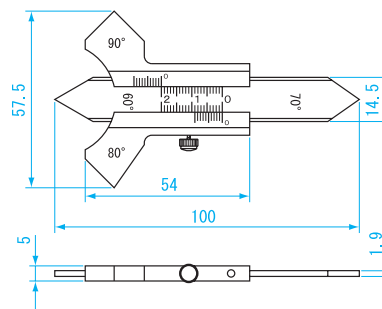

**USE** • Use for measuring the size of fillet weld and bead weld

**MATERIAL** • Stainless steel

**FEATURES** • Bevel angle: 60° 70° 80° 90°

### SPECIFICATIONS

- Fillet weld : 11mm
- Bead weld : 8mm
- Accuracy: ± 0.2mm
- Minimum reading : 0.1mm

Weld Bead Measurement

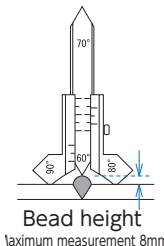

Measurement Before Welding

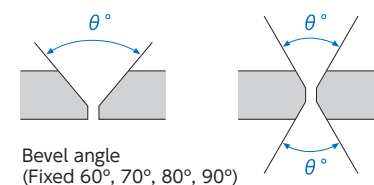

Order No.	Model No.	Weight
007516	AWG-10	80g